

# Kingtronics®

## RKT-WE

### Wirewound Potentiometer

#### Electrical Characteristics

Standard Resistance Range	100Ω~47KΩ
Resistance Tolerance	±5%
Independent Linearity	±0.3%
Rated Power	1W(55°C)
Voltage Rating	160V

#### Mechanical Characteristics

Total Mechanical Travel	1800°±20°
Starting Torque	3.5-100mN.m

#### Common Dimensions

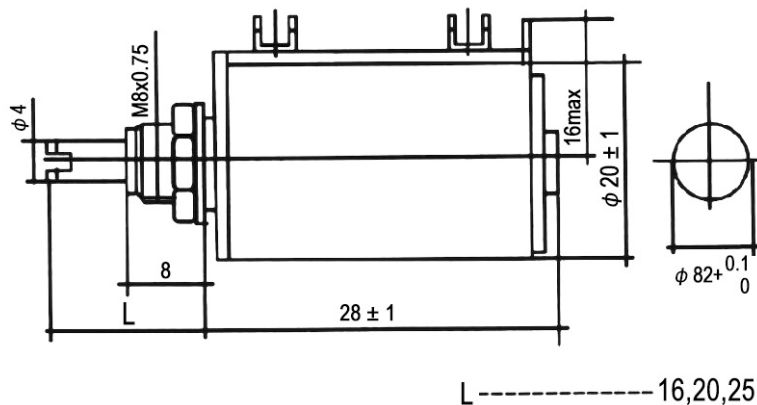

Note: Specifications are subject to change without notice.

**Kingtronics® International Company**

Website: [www.kingtronics.com](http://www.kingtronics.com) Email: [info@kingtronics.com](mailto:info@kingtronics.com) Tel: (852) 8106 7033 Fax: (852) 8106 7099