

Kingtronics®

KBU6005 THRU KBU610

GLASS PASSIVATED BRIDGE RECTIFIERS

REVERSE VOLTAGE 50 to 1000 Volts FORWARD CURRENT 6.0 Ampere

FEATURES

- Surge overload rating -150 amperes peak
- Ideal for printed circuit board
- Reliable low cost construction utilizing molded plastic technique
- Plastic material has UL
- Mounting position:Any
- Mounting torque:5 In.lb.Max
- Weight: 0.23ounces ,6.55grams

KBU

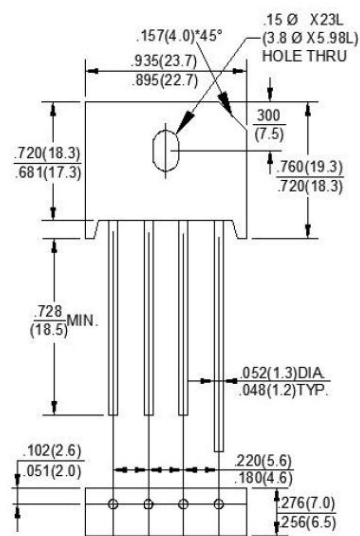

Dimensions in inches and (millimeters)

MAXIMUM RATINGS AND ELECTRICAL CHARACTERISTICS

Rating at 25°C ambient temperature unless otherwise specified.
Single phase, half wave ,60Hz, resistive or inductive load.
For capacitive load, derate current by 20%

CHARACTERISTICS	KBU 6005	KBU 601	KBU 602	KBU 604	KBU 606	KBU 608	KBU 610	UNIT
Maximum Repetitive Peak Reverse Voltage	50	100	200	400	600	800	1000	V
Maximum RMS Voltage	35	70	140	280	420	560	700	V
Maximum DC Blocking Voltage	50	100	200	400	600	800	1000	V
Maximum Average Forward Rectified Output Current at T _A =50°C/40°C/45°C	6.0							A
Peak Forward Surge Current 8.3ms single Half Sine-Wave Super Imposed on Rated Load (JEDEC Method)	150							A
Maximum Instantaneous Forward Voltage Drop per Element at 3.0A	1.1							V
Maximum Reverse Leakage at rated T _A =25°C DC Blocking Voltage Per Element T _A =100°C	10							μA
	1000							mA
Operating and Storage Temperature Range T _J .TSTG	-55 to +150							°C

Kingtronics® International Company

Website: www.kingtronics.com Email: info@kingtronics.com Tel: (852) 8106 7033 Fax: (852) 8106 7099

Kingtronics®

KBU6005 THRU KBU610

GLASS PASSIVATED BRIDGE RECTIFIERS RATING AND CHARACTERISTIC CURVES

FIG.1-DERATING CURVE FOR
OUTPUT RECTIFIED CURRENT

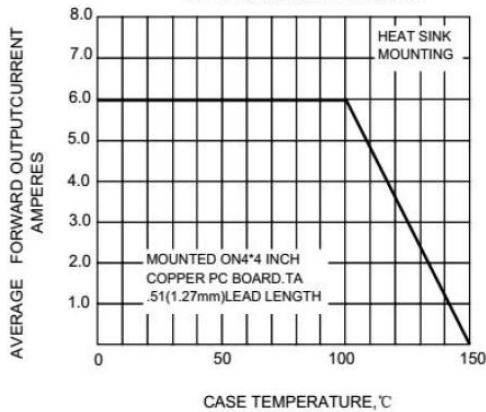

FIG.2 TYPICAL INSTANTANEOUS FORWARD
CHARACTERISTIC

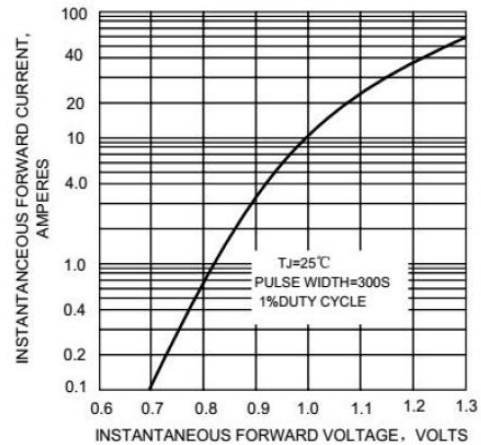

FIG.3-MAXIMUM NON-RETETITIVE PEAK
FORWARD SURGE CURRENT

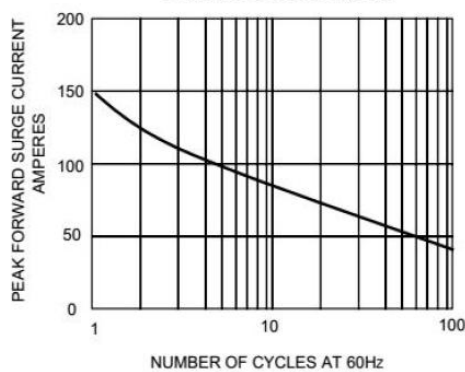

FIG.4-TYPICAL REVERSE
CHARACTERISTICS

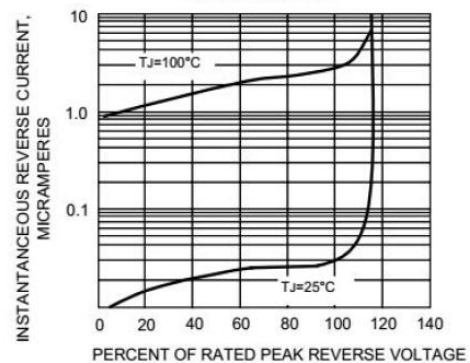
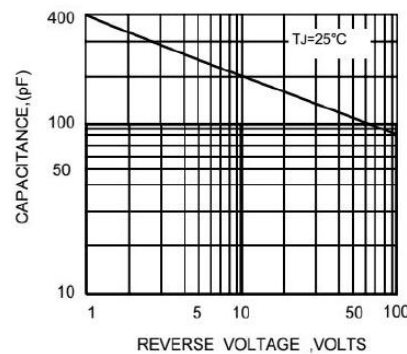

FIG.5-TYPICAL JUNCTION CAPACITANCE PER ELEMENT



Note: Specifications are subject to change without notice.

Kingtronics® International Company

Website: www.kingtronics.com

Email: info@kingtronics.com

Tel: (852) 8106 7033

Fax: (852) 8106 7099